

Performance Standard	
Nominal Bore	2"~4" NPS
Nominal Pressure	300 Lb
Pressure test	
Shell Test	5.0
Seal Test	2.5
Backseat test	/
Air Test	/
Working Temperature	-29°C ~ +200°C
Suitable Medium	Water, Oil, Corrosive fluids

### Technical Requirements

1. Height dimension (H) standard as to: MFR-STD
2. Design & Manufacture as to: ASME B31.3
3. Flange dimension conforms as to: ASME B16.5  
Finish, Flange facing : RA=3.2-6.4 Micron
4. Testing record as to: API 598
5. Pressure-temperature conforms as to: ASME B16.34
6. Suitable Medium: Water, Oil, Corrosive fluids, etc

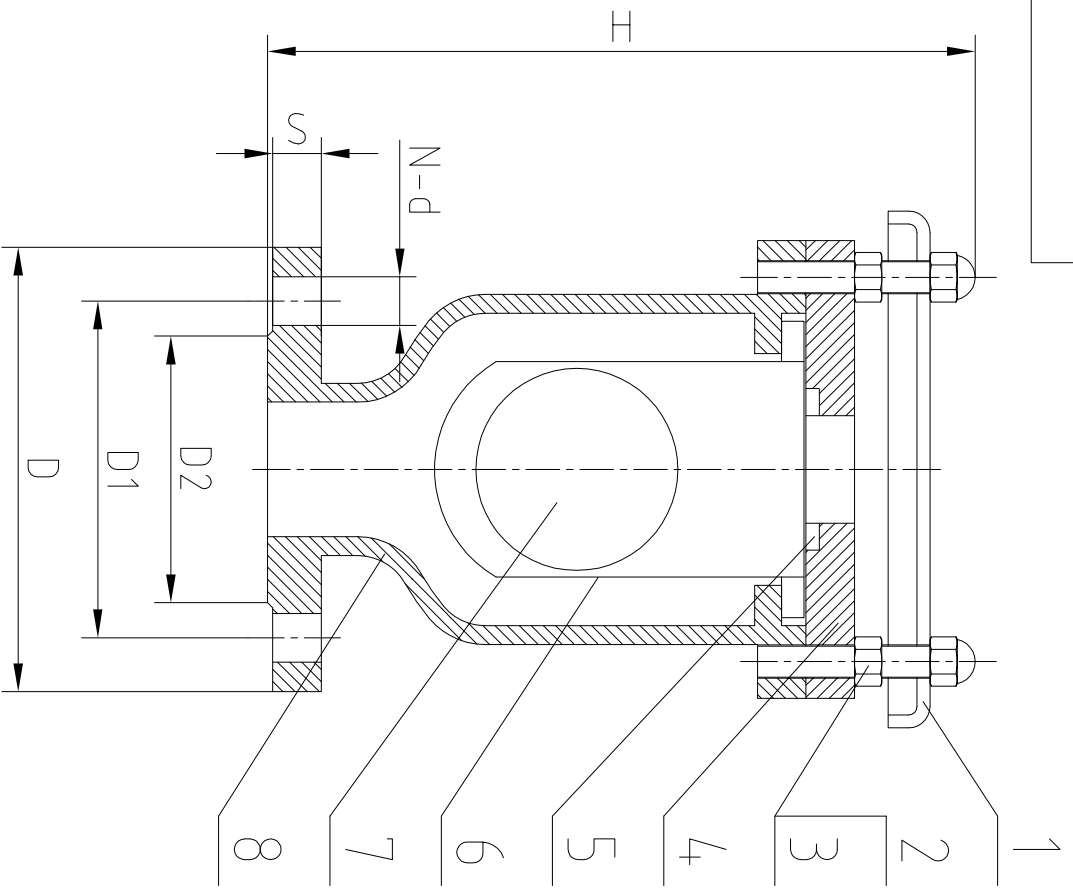

Test	API 598	API 598
1.1 Hydro Static Test	Yes	Yes
1.2 Working Pressure Test	Yes	Yes
1.3 Chemical composition certification	Yes	Yes
1.4 Working pressure test up to 725 PSI	Yes	Yes
1.5 Penetrant Test	Yes	Yes
1.6 Magnetic Particle Test	Yes	Yes
1.7 Maximum Working pressure on 725 PSI	Yes	Yes

NO.	Name	Material
1.	Cap	A182 F304
2.	Bolt	A193 Gr. 8M
3.	Nut	A194 Gr. 8M
4.	Cover	A182 F316L
5.	Gasket	VITON
6.	Protective Bushing	A276 SS316L
7.	Floating ball	A276 SS316L
	Body	A351 CF3M

SIZE NPS	H		D		D1		D2		S	N-ød	F
	260	165	127	92	21	8-ø19	1.6				
3"	270	210	168.3	127	27	8-ø22	1.6				
4"	300	255	200	157	30.5	8-ø22	1.6				

Omega Model  
Double Effect Air Vent

2"~4"-300LB  
RF CF3M/SS316L

Drawing No. :